

*Boundaries  
Without  
Limits*

**Phone**

Tel: 01608 678238

**Web**

Web:  
[www.duralocksports.com](http://www.duralocksports.com)  
Email:  
[sales@duralock.com](mailto:sales@duralock.com)

**Address**

Duralock UK Ltd  
6A Enstone Business Park,  
Enstone, Chipping Norton,  
Oxfordshire OX74NP

# DURALOCK SPORTS

— PERFORMANCE FENCING —



# DURALOCK IS THE MARKET LEADING, HIGH PERFORMANCE FENCING SYSTEM



Repton School



*Boundaries Without Limits*

# INTRODUCTION

*Duralock is the market leading, high performance fencing system that delivers in every respect.*

Safe and robust, the award winning PVC-u construction withstands heavy use in all weathers, making Duralock ideal for a broad range of applications.

Established more than two decades ago, Duralock has developed into a world-renowned company, focused on delivering the finest equestrian and sports fencing. Produced in the UK and shipped Worldwide, we have a truly international reach, with clients across the globe.

Duralock Sports Performance Fencing has been developed specifically with sports in mind and is approved by sports governing bodies Worldwide. From The Premier League through to grassroots clubs, our patented system suits all.

All of our fencing systems use an award winning patented dual chamber design and are suitable for use on all surfaces, from natural turf, to artificial surfaces.

Duralock Performance Fencing prides itself on **quality, substance** and **professionalism**.

# DURALOCK

— PERFORMANCE FENCING —



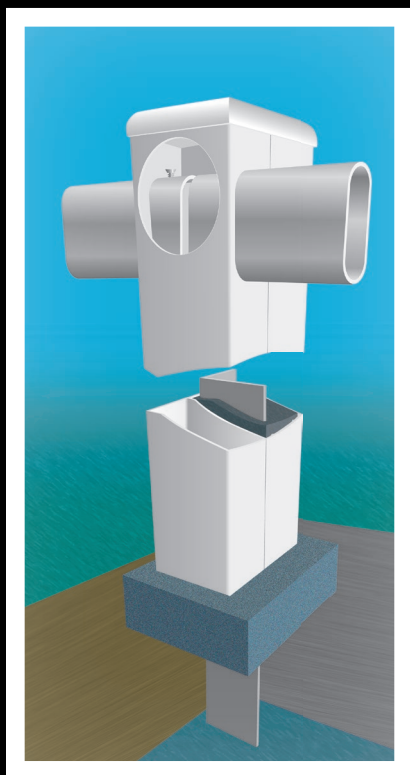

- › **Strong**  
PVC-u formulation with impact modifiers provides incredible strength.
- › **Durable**  
Ultraviolet inhibitors protect the PVC-u from the sun. Duralock fencing will not warp, split, peel or splinter.
- › **Safe**  
The smooth, rounded surfaces and concealed fixings of the system make Duralock fencing exceptionally safe.
- › **Easy to Install**  
Duralock's patented, award-winning design makes self-installation simple and straight-forward.
- › **Maintenance-Free**  
Once installed the investment is complete. Nails, paint, rotting posts and cribbed rails become things of the past.

---

## **FLEXIBLE SYSTEMS**

### **SWITCH THE PLAY.**

All Duralock fencing products are available as permanent, demountable or removable fixtures.

Permanent installations can be fixed with steels surrounded by concrete in one side of our signature patented dual chamber post, achieving a strong and robust installation.

Does your fencing need to be removed seasonally? If so, our demountable system with extended posts will suit your needs – the same as our permanent systems, our demountable system enables you to take down your fencing at the end of the season – caps can be supplied to cover the sockets when the fencing is removed.

Especially developed 'feet' for 2 or 3 metre sections are available for temporary boundaries that you may wish to move and store, making them ideal for multi-use sports facilities.

---

*Boundaries Without Limits*



# **WHY CHOOSE DURALOCK**

## **DURALOCK OFFERS A FULL SERVICE FROM PROJECT START TO FINISH :-**



### **CONSULT**

Duralock have an in-house team of technicians who are able to advise and support throughout your project.



### **DESIGN**

With a wide project range available we are able to design a package to suit your individual requirements.



### **SUPPLY**

We are proud that all of our products are handmade in Britain.



### **SHIP**

Our logistics team have the experience of shipping in mainland UK and globally.



### **INSTALL**

We have both an in-house installation team, as well as a large number of accredited installers worldwide.



### **MAINTAIN**

Whilst Duralock products require little maintenance and can be managed by you, we offer numerous packages to support your needs.

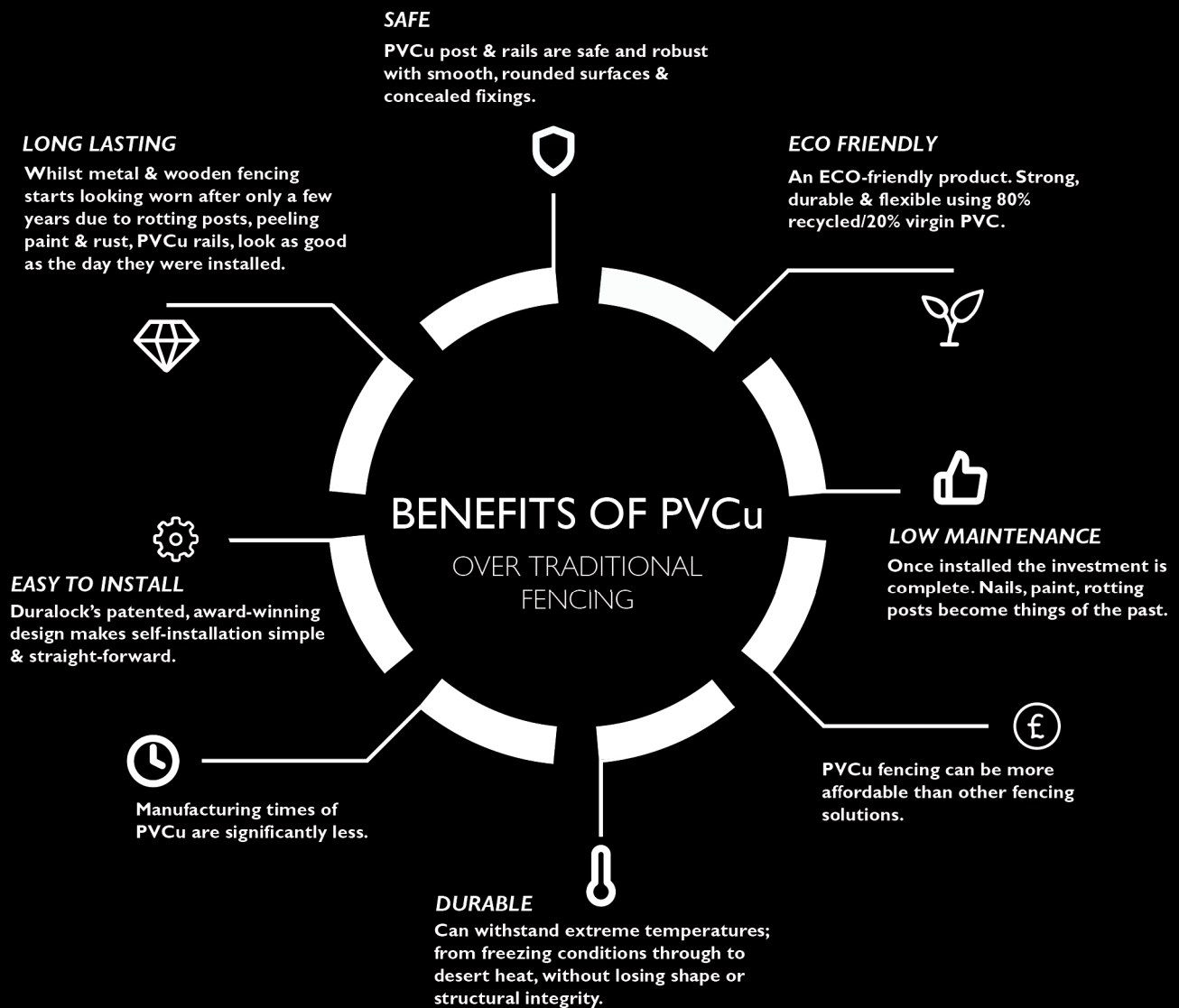

*Boundaries Without Limits*

# MULTI SPORT HALF MESH



## A LEADER ON THE PITCH.

Designed specifically for sports clubs, our half mesh design prevents the ball from leaving the field of play.

This robust fence is strong enough to withstand heavy treatment, which means no worries about how they'll stand up to crowds or spectators.

**DURALOCK**  
PERFORMANCE FENCING

CROWD BARRIER WITH HALF MESH INFILL [PR1200/3-HALFMESH]

**MADE IN BRITAIN**

VERSION: 1 - 08.2018

PAGE: 18B

DURALOCK FENCING LTD  
RESERVE THE RIGHT TO ALTER  
SPECIFICATIONS WITHOUT  
NOTICE

ALL DIMENSIONS ARE  
NOMINAL PLEASE CHECK IF  
CRITICAL

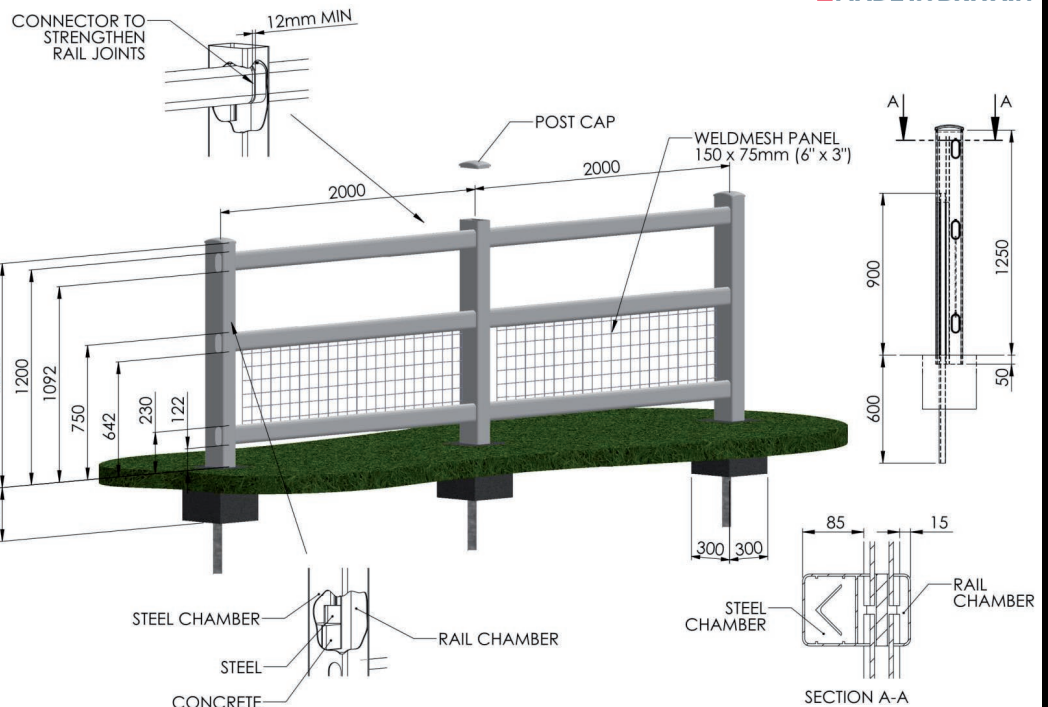

### CONTACT

t: +44 (0)1608 678238  
e: SALES@DURALOCK.COM  
w: WWW.DURALOCK.COM

### COMPONENTS:

- 100MM X 150MM POST
- 100MM X 150MM POST CAP
- WELDMESH PANEL
- 108MM X 50MM DRILLED RAIL
- 50MM X 50MM X 3MM, 1.5M LONG GROUND FIXING STEEL

DURALOCK (UK) LTD  
ENSTONE BUSINESS PARK  
ENSTONE  
OXFORDSHIRE  
OX7 4NP



# SPECTATOR RAIL



## A TEAM PLAYER.

Duralock spectator rail is safe & robust and offers a clear demarcation between spectators & officials.

The rail is available in all sizes to conform to national governing body pitch dimensions, with suitable telescopic access points.

**DURALOCK**  
PERFORMANCE FENCING

SPECTATOR RAIL [SPR9501]

**MADE IN BRITAIN**

VERSION: 1 - 08.2018  
PAGE: 18C

DURALOCK FENCING LTD  
RESERVE THE RIGHT TO ALTER  
SPECIFICATIONS WITHOUT  
NOTICE

ALL DIMENSIONS ARE  
NOMINAL PLEASE CHECK IF  
CRITICAL

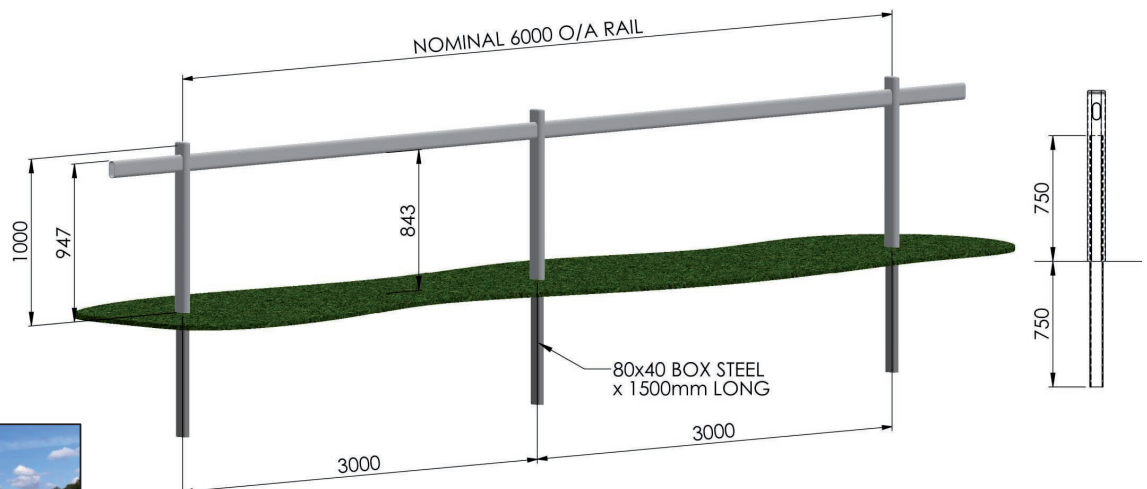

### CONTACT

t: +44 (0)1608 678238  
e: SALES@DURALOCK.COM  
w: WWW.DURALOCK.COM

### COMPONENTS:

- CONNECTOR RAIL
- RAIL CAPS
- 108MM X 50MM RAIL
- BOX STEEL GROUND FIXING

DURALOCK (UK) LTD  
ENSTONE BUSINESS PARK  
ENSTONE  
OXFORDSHIRE  
OX7 4NP

*Boundaries Without Limits*

# POST AND RAIL



## FENCING WITH STAMINA.

You need a fencing system you can trust on safety. Duralock fencing won't let the team down.

We've designed it to flex under impact, reducing the risk of injury. And we've cut out the sharp bits: concealed fixings and smooth rounded surfaces make the whole system exceptionally safe.

**DURALOCK**  
PERFORMANCE FENCING

POST AND 2 RAIL FENCING [PR1200/2]

VERSION: 1 - 08.2018  
PAGE: 15A

DURALOCK FENCING LTD  
RESERVE THE RIGHT TO ALTER  
SPECIFICATIONS WITHOUT  
NOTICE

ALL DIMENSIONS ARE  
NOMINAL PLEASE CHECK IF  
CRITICAL

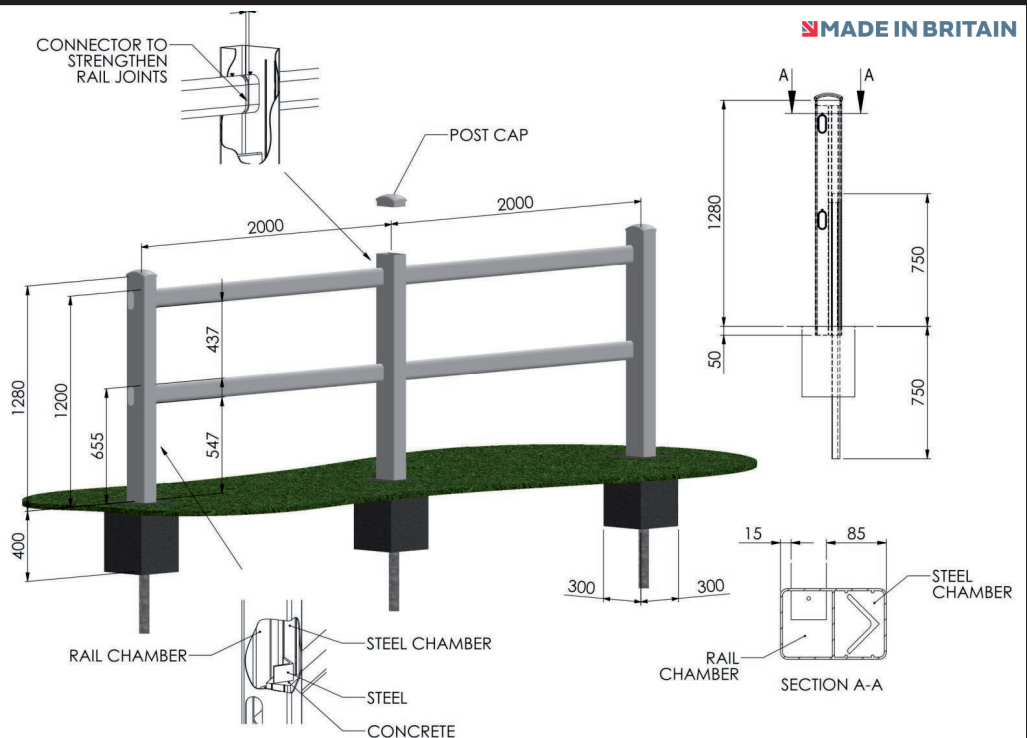

### CONTACT

t: +44 (0)1608 678238  
e: SALES@DURALOCK.COM  
w: WWW.DURALOCK.COM

### COMPONENTS:

- 100MM X 150MM POST
- 100MM X 150MM POST CAP
- 108MM X 50MM RAIL
- 50MM X 50MM X 3MM, 1.5M LONG GROUND FIXING STEEL

DURALOCK (UK) LTD  
ENSTONE BUSINESS PARK  
ENSTONE  
OXFORDSHIRE  
OX7 4NP



# PICKET FENCING



## THE ALL ROUNDER.

Duralock picket fencing brings you the iconic look of a white picket fence in zero-maintenance, hard-wearing PVC-u. Our picket fencing is the perfect solution for pitch and pavilion.

Impressive and smart, Duralock picket is sure to make staff, players and spectators proud of their club. Duralock also boasts advanced safety; with concealed fixings, smooth edges and non-splintering, it is also extremely strong and durable.

**DURALOCK**  
PERFORMANCE FENCING

PICKET FENCING [PK900/2]

**MADE IN BRITAIN**

VERSION: 1 - 09.2018

PAGE: 41

DURALOCK FENCING LTD  
RESERVE THE RIGHT TO ALTER  
SPECIFICATIONS WITHOUT  
NOTICE

ALL DIMENSIONS ARE  
NOMINAL PLEASE CHECK IF  
CRITICAL

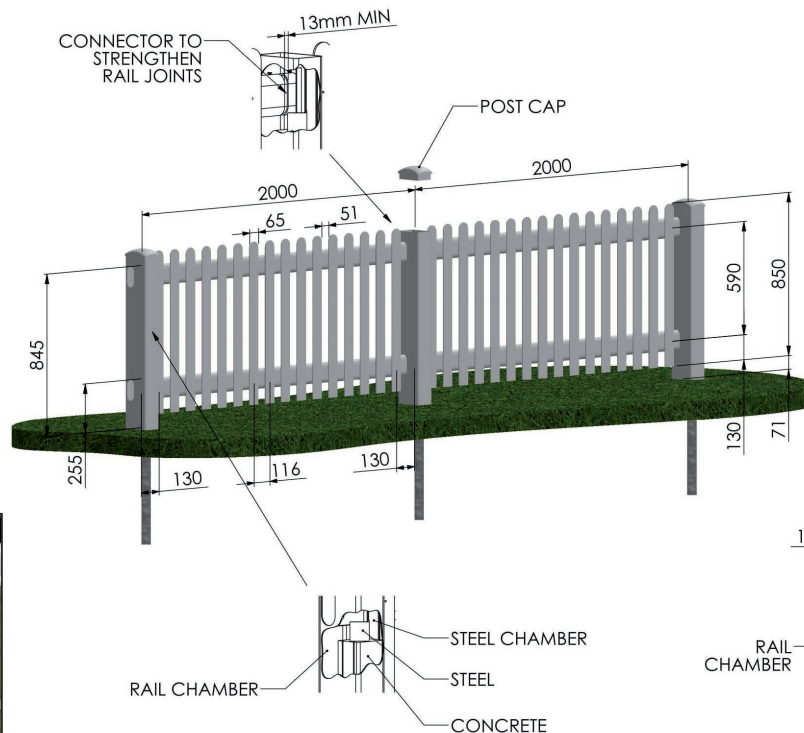

### CONTACT

t: +44 (0)1608 678238  
e: SALES@DURALOCK.COM  
w: WWW.DURALOCK.COM

### COMPONENTS:

- 100MM X 150MM POST
- 100MM X 150MM POST CAP
- PICKET SLAT
- 108MM X 50MM RAIL
- 50MM X 50MM X 3MM, 1.5M LONG GROUND FIXING STEEL

DURALOCK (UK) LTD  
ENSTONE BUSINESS PARK  
ENSTONE  
OXFORDSHIRE  
OX7 4NP

*Boundaries Without Limits*



# MOVEABLE BARRIERS



## A TACTICAL DECISION.

In addition to our fixed fence systems, we also offer stable and flexibly deployable mobile fences.

On customer request, we also deliver every “fixed” system as a mobile version. The mobile fences are ideal for use at events and fairs, where separation is needed.

**DURALOCK**  
PERFORMANCE FENCING

POST AND 2 RAIL MOVEABLE BARRIER [PRM1200/2-3M]

**MADE IN BRITAIN**

VERSION: 1 - 08.2018

PAGE: 58C

DURALOCK FENCING LTD  
RESERVE THE RIGHT TO ALTER  
SPECIFICATIONS WITHOUT  
NOTICE

ALL DIMENSIONS ARE  
NOMINAL PLEASE CHECK IF  
CRITICAL

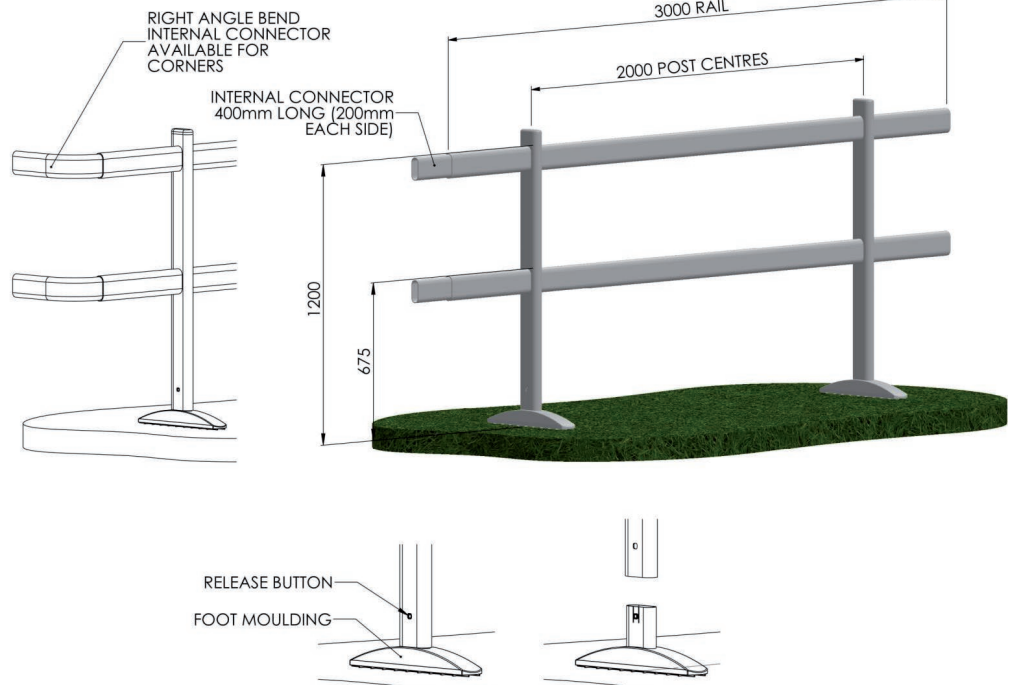

### CONTACT

t: +44 (0)1608 678238  
e: SALES@DURALOCK.COM  
w: WWW.DURALOCK.COM

### COMPONENTS:

- CONNECTOR RAIL
- RAIL CAPS
- 108MM X 50MM RAIL
- REMOVEABLE BALAST FEET

DURALOCK (UK) LTD  
ENSTONE BUSINESS PARK  
ENSTONE  
OXFORDSHIRE  
OX7 4NP



## GATES



### A SAFE PAIR OF HANDS.

We also offer suitable gates for each of our fencing systems. We can design and install a variety of types of gate to suit your facility. From a small gate only for pedestrians to large coupling or rolling gates for the use of heavy machinery.



*Boundaries Without Limits*



# ADVERTISING BOARD CLIPS



## REVOLUTIONISE YOUR PITCH.

Our fencing solutions are designed to enable you to maximise advertising revenue. An average of £4000 per pitch per annum can be generated from the sale of advertising boards. Our bespoke Duralock clips are available to allow for an easy changeover.

The clips are suitable for use on both the Multi-Sport Half mesh and Post & Rails systems.

**DURALOCK**  
PERFORMANCE FENCING

ADVERTISING BOARD CLIPS

**MADE IN BRITAIN**

VERSION: 1 - 08.2018  
PAGE: 144

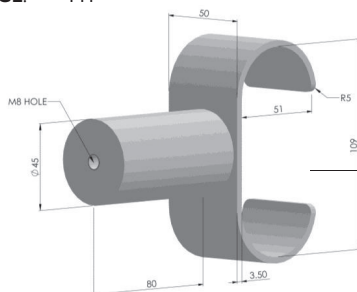

OUTSIDE AD BOARD CLIPS (CROWD FACING CLIPS)

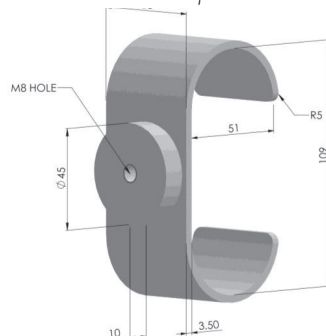

INSIDE AD BOARD CLIPS (PLAYER FACING CLIPS)

DURALOCK FENCING LTD  
RESERVE THE RIGHT TO ALTER  
SPECIFICATIONS WITHOUT  
NOTICE

ALL DIMENSIONS ARE  
NOMINAL PLEASE CHECK IF  
CRITICAL

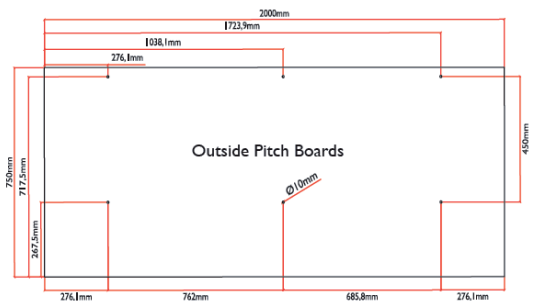

Outside Pitch Boards

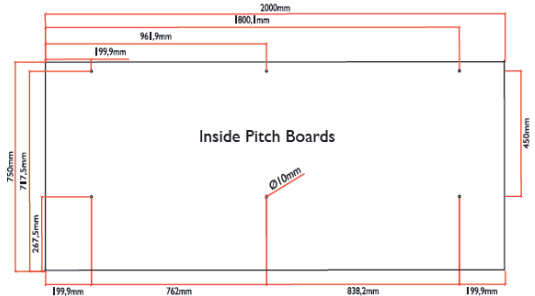

Inside Pitch Boards

### CONTACT

t: +44 (0)1608 678238  
e: SALES@DURALOCK.COM  
w: WWW.DURALOCK.COM

DURALOCK (UK) LTD  
ENSTONE BUSINESS PARK  
ENSTONE  
OXFORDSHIRE  
OX7 4NP



*The transformation was amazing, providing a professional, durable and clean fencing system. I would recommend Duralock without hesitation to anyone looking for a fencing system. The sales and after sales teams have been quick and efficient throughout*

MATT GAMON, GENERAL MANAGER  
AYLESBURY RUGBY CLUB



*Boundaries Without Limits*









# DURALOCK

— PERFORMANCE FENCING —



TELEPHONE  
+44 (0)1608 678238

VISIT OUR WEBSITE  
[www.duralock.com](http://www.duralock.com)

EMAIL  
[sales@duralock.com](mailto:sales@duralock.com)

DURALOCK UK LTD. 6A ENSTONE BUSINESS PARK, ENSTONE, CHIPPING NORTON, OXFORDSHIRE, OX7 4NP